

TOTAL SOLUTIONS®

WET WIPES

CART HANDLE WIPES

One-Step Cleaner

- EXCELLENT FOR CLEANING AND DEODORIZING SHOPPING CART HANDLES AND SURFACES



Do Not Flush

KEEP OUT OF REACH OF CHILDREN

NET CONTENTS: 450

6" x 6" (15.24 cm x 15.24 cm) Premoistened Wipes

Manufactured By: Total Solutions® • 1-800-743-6417
PO Box 240014 • Milwaukee, WI 53224 • athea.com

DIRECTIONS FOR DISPENSING

1. Remove lid by lifting upward. Remove foil seal.
2. Pull towel from center of the roll and thread through "X" on the underside of the lid.
3. Close lid. Pull towel at 90° angle.
4. Snap hinged cap back into place to ensure towels stay moist.

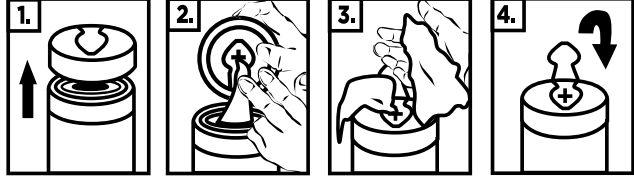

DISPOSAL

Offer empty container for recycling. If recycling is not available, discard container in trash. Do not flush wipes.

NFPA® RATINGS

Health: 1; Flammability: 1; Reactivity: 0

CONTAINS/CAS NUMBER:

Water/7732-18-5; C7-21 Alcohols
Ethoxylated/68991-48-0; Alkyl C12-18 Dimethylbenzyl Ammonium Chloride/68391-01-5; Alkyl C12-14 Dimethylbenzyl Ammonium Chloride/85409-23-0; Ethanol/64-17-5

*For industrial and commercial use only.
For additional information, see Safety Data Sheet.*



Please Recycle.

Canister made from 25% post-consumer recycled plastic.

1574.022322

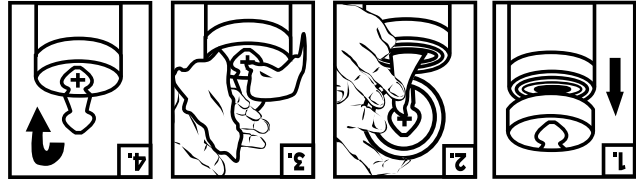

- DIRECTIONS FOR DISPENSING**
1. Remove lid by lifting upward. Remove foil seal.
 2. Pull towel from center of the roll and thread through "X" on the underside of the lid.
 3. Close lid. Pull towel at 90° angle.
 4. Snap hinged cap back into place to ensure towels stay moist.

DISPOSAL
Offer empty container for recycling. If recycling is not available, discard container in trash. Do not flush wipes.

NFPA® RATINGS
Health: 1; Flammability: 1; Reactivity: 0

CONTAINS/CAS NUMBER:

Water/7732-18-5; C7-21 Alcohols
Ethoxylated/68991-48-0; Alkyl C12-18 Dimethylbenzyl Ammonium Chloride/68391-01-5; Alkyl C12-14 Dimethylbenzyl Ammonium Chloride/85409-23-0; Ethanol/64-17-5

*For industrial and commercial use only.
For additional information, see Safety Data Sheet.*



Please Recycle.

Canister made from 25% post-consumer recycled plastic. 1574.022322

TOTAL SOLUTIONS®

WET WIPES

CART HANDLE WIPES

One-Step Cleaner

- EXCELLENT FOR CLEANING AND DEODORIZING SHOPPING CART HANDLES AND SURFACES



Do Not Flush

KEEP OUT OF REACH OF CHILDREN

NET CONTENTS: 450

6" x 6" (15.24 cm x 15.24 cm) Premoistened Wipes

Manufactured By: Total Solutions® • 1-800-743-6417
PO Box 240014 • Milwaukee, WI 53224 • athea.com